

GRIP CORE

Kitagawa series: GRIP-3.5-1.8-2



- Apply onto discrete devices on PCBs without adhesive or bonding.
- Eliminates adhesive residue on PCBs.
- Excellent EMI suppression achieved.

Material: Soft ferrite enclosed in silicone rubber.

Part Number	Profile	Height	Cylindrical Lead O.D.	Rectangular Leadcross-sectional dimension
GRIP-3.5-1.8-2	Ø4.4	2.8	Ø0.6 ~ 1.6	0.8 ~ 1.5 (Width) / 0.3 ~ 0.7 (Thickness)

Dimensions in mm

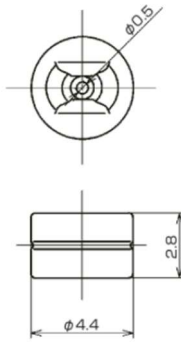

Impedance vs frequency

